

CAUTION

TURN THIS PAGE OVER AND
YOU WILL NEVER WANT TO GET OUT
OF WATER AGAIN. EVER...



Greetings!

from all of us at
Aquascape India Pvt. Ltd.

Aquascape is one of the pioneers that led the water leisure revolution mushrooming in India nearly twenty five years ago. The Company started out developing and constructing

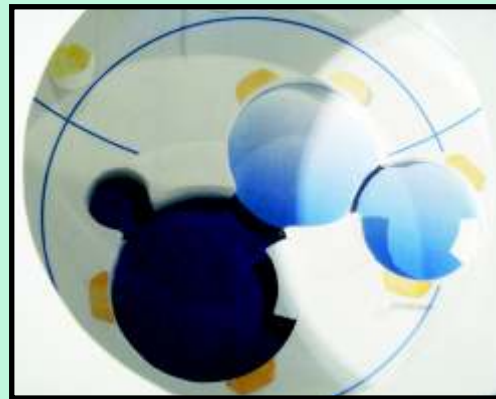

AQUASCAPE Creation

swimming pools but was quick to focus on international products and technology.

Aquascape made water an industry. Technologically superior products from Germany were soon followed by water parks, wave generating products, ceramic pools and spas from European

countries and USA, placing Aquascape way ahead of any competition.

Today, after two decades of Research & Development Aquascape has positioned itself as a brand leader offering safe, chemical free, water management. The Company's technical collaboration with dinotech GmbH, Germany's Pool & Wellness Technology major, has placed it right on top of the



WATER FRONT CLUB, MUMBAI an AQUASCAPE project

industry's growth curve and aligned to international standards. Several projects all over India bear testimony to the degree of services and expertise Aquascape is able to offer. Essel World's Water Kingdom, Waterfront Club, Millennium Club, Matunga Gymkhana, American School, and Police Gymkhana are some of the mega projects in Mumbai. Aquascape has installed semi olympic size pools and leisure pools in several five star hotels, resorts and institutes.

Though chemical free water management is the core business, Aquascape still leads in the world of designing, constructing and turnkey projects of all types of pools, water parks and wellness.



AQUASCAPE Creation



Aquascape, Kohinoor Corner, V. S. Marg, Prabhadevi, Mumbai - 400 025
T: +91 22 6610 2940 / 6610 2950 F: +91 22 666 8882 Mob.: +91 989 25 10002
E: kishoramrutkar@gmail.com www.aquascapeworld.com

OUR SPECTRUM OF PERFORMANCE

☆ Project-related interior spa area works taking into account construction and architectural aspects.

☆ Individual consultation, planning and execution of pools and wellness.

☆ Application of different pool and whirlpool systems as per individual specifications.

☆ Use of high-quality water treatment facilities (*chemical free*) with high operating comfort.

☆ Design and plan relaxing and stimulating water attractions and counter current systems.

☆ Efficient climate and de-humidification systems including energy optimization and heat recovery.

☆ Exclusive saunas, steam baths, heated benches, showers, fitness devices.

☆ Design & plan swimming pool covers and roofs.

☆ Modernization and rebuilding of existing pools.

☆ Aquascape, having created an awareness of the perils of chlorinated water on human health & environment, offers substantial alternatives to ensure water purity naturally with little or no chemicals. dinotec's Blue Tech undivided cell electrolysis systems offer on-site production of fresh, highly active disinfection solutions with benefits like reduced chemical consumption, optimum water quality, protection of health etc.

Aquascape has spent years researching and developing the process and is now confident that it holds the key to safe water treatments.



Aquascape, Kohinoor Corner, V. S. Marg, Prabhadevi, Mumbai - 400 025
T: +91 22 6610 2940 / 6610 2950 F: +91 22 666 8882 Mob.: +91 989 25 10002
E: kishoramrutkar@gmail.com www.aquascapeworld.com

Aquascape is fast unveiling the world of unending water possibilities.

That's Spa & Wellness projects across Club houses, Hotels, Institutes, Corporations, Country Homes, City Residences, et al. With an informed, discerning eye that comes with an experience of over 25 years which goes beyond Architectural aspects.
Consultation, Designing, Development, Creation and Construction.

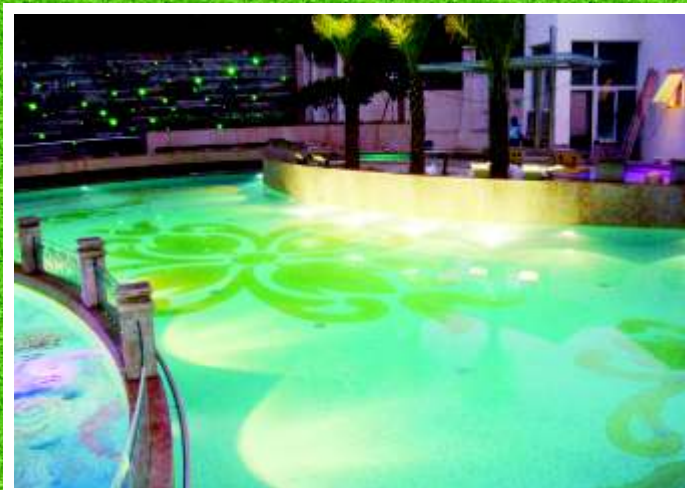

PROJECT : Leisure Pool LOCATION : Pune, Maharashtra
DESIGN & DEVELOPMENT :

Kishor Amrutkar Associates
A division of AQUASCAPE India Pvt. Ltd.

One Stop Shop for Swimming Pools & Spas



Add Picture

AQUASCAPE®

Water!
We made it
an industry
in India.

Safety cover!



Instant kid-pool!



Celebration



Now simply relax in hot or cold water
whenever. Wherever.

HYDROJETS, FILTRATION, HEATING, OZONATION & SAFETY COVER.



Built in Jacuzzi!



- Portable.
- Light weight
- Any time
- Anywhere
- Easy-fix.
- FUN TUBS!**

Softub®
MADE IN USA





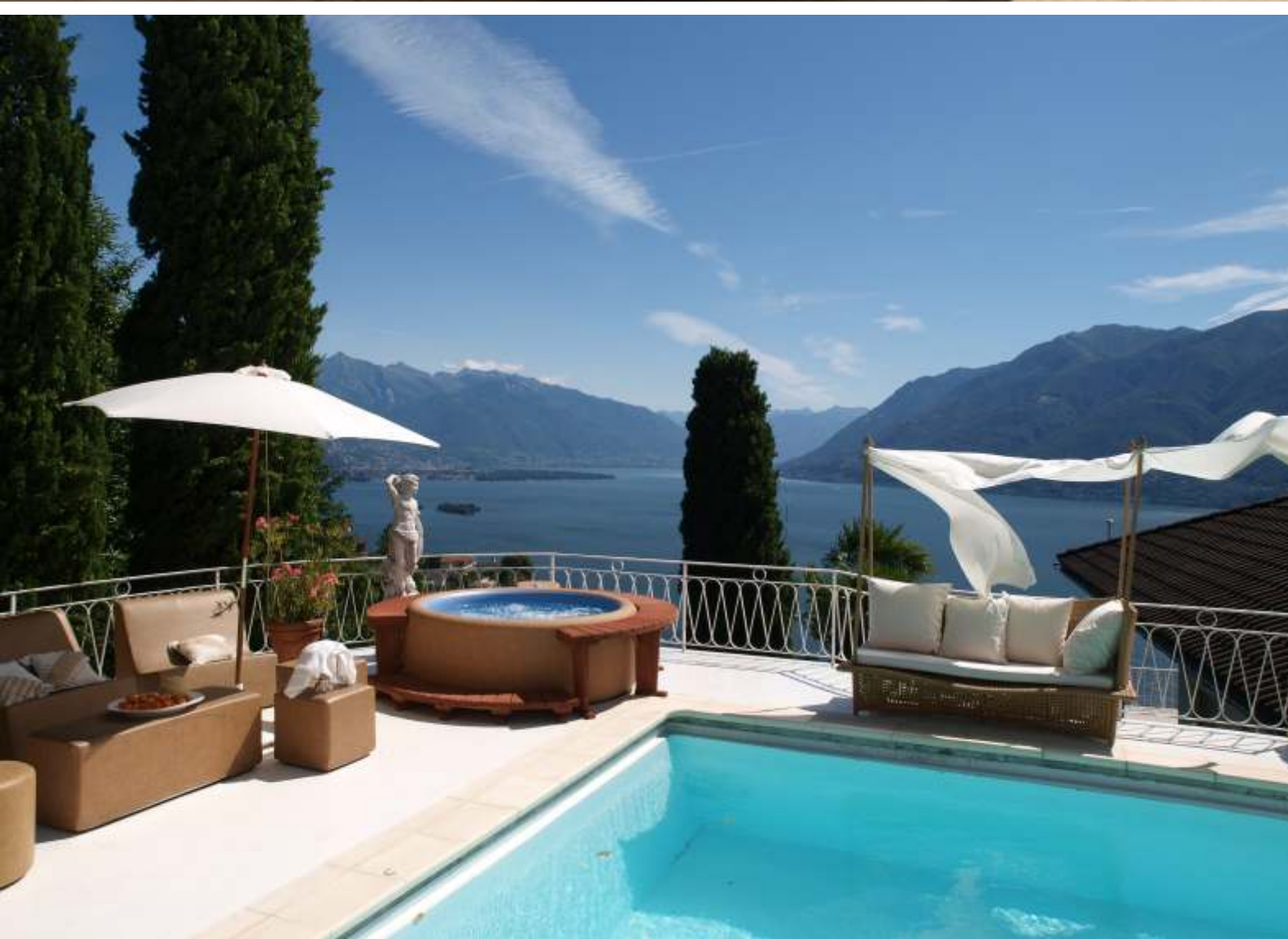





AQUASCAPE®

Water!
We
made it
an
industry
in
India.

The science of a totally pipeless, single unit filtration system!



• Unique!
• Single Unit!
• Multi-
functional!
Filtration
System



Filtration & Counter Current Systems
can be used individually or collectively
in existing pools too.

• NO PIPES
• NO
LEAKAGES
• NO
PLANT ROOM
• NO
BALANCING
TANK



COUNTER
CURRENT
generating
single unit
system!
Imagine the joy
of swimming
against currents
CAN BE USED IN
EXISTING POOLS



MADE IN FRANCE









The pool
that cleans
itself

More Than 60,000 Ceramic Pools Installed Worldwide

- World's first patented ceramic composite pool technology.
- World first brilliant Bi-luminite colour finish creating water colours of unmatched depth and luminosity
- World's first self Cleaning and Circulation System
- Engineered self supporting pool technology for all situations

Compass 
Ceramic Pools Europe



IMPORTED from EUROPE

First time in India ready-to-fit ceramic swimming pools!

NO JOINTS. NO LEAKAGES. ONLY SPARKLING CLEAN WATER!



Every Function
of your Ceramic pool
Remote controlled!



[®]
AQUASCAPE
Water!
We
made it
an
industry
in
India.

AQUASCAPE®

Water!
We made it
an
industry
in
India.

Your dreams come true
in just a few days!!!

MORE THAN
100,000
COMBINATIONS
AVAILABLE
IN MAGILINE
LINER POOLS



SWIMMING POOLS
Magiline
PASSION FOR POOLS
MADE IN FRANCE





AQUASCAPE Project



AQUASCAPE Project

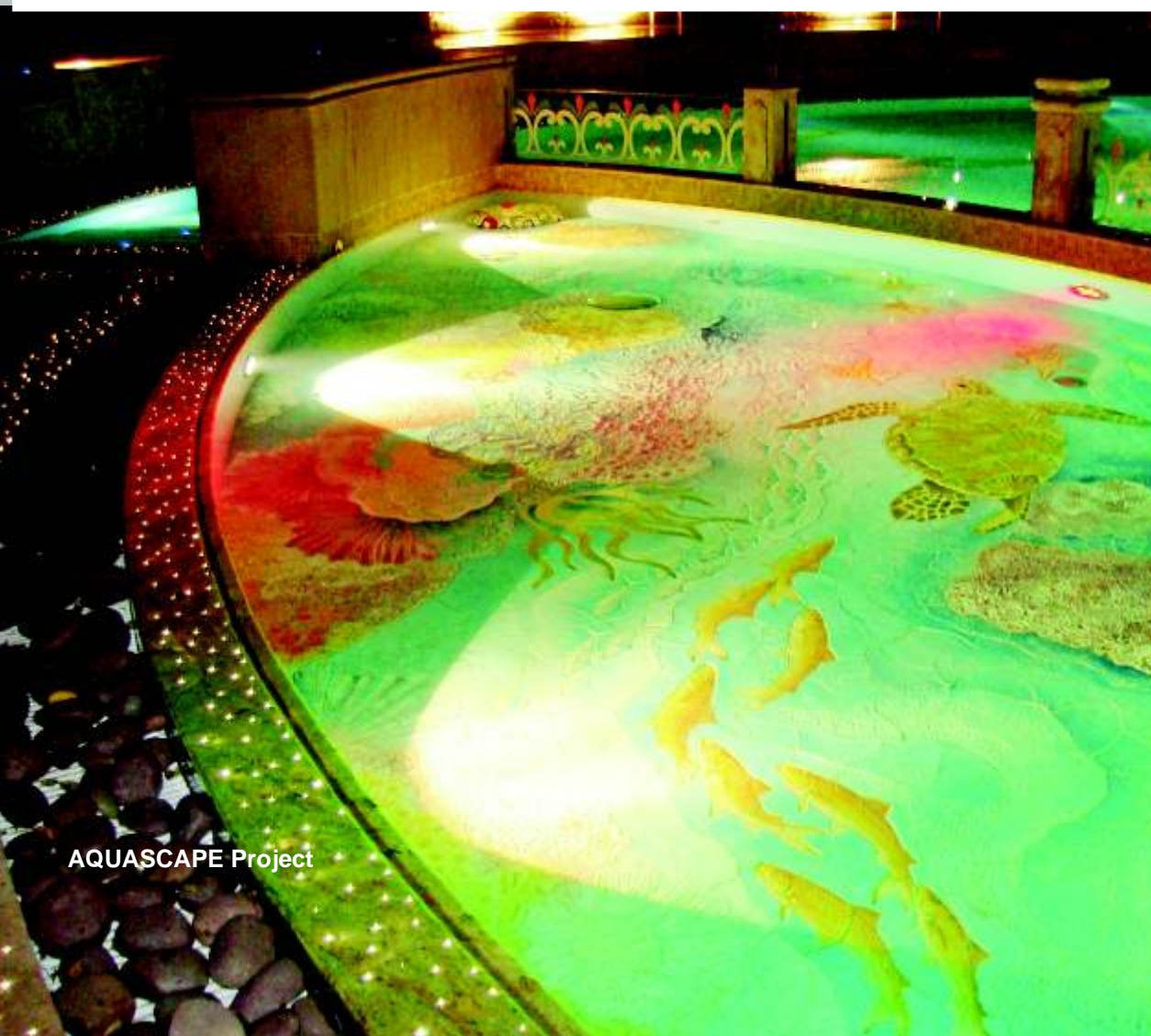

AQUASCAPE Project



AQUASCAPE Project

AQUASCAPE®

Water!
We
made it
an
industry
in
India.

AQUASCAPE®

Water!
We
made it
an
industry
in
India.

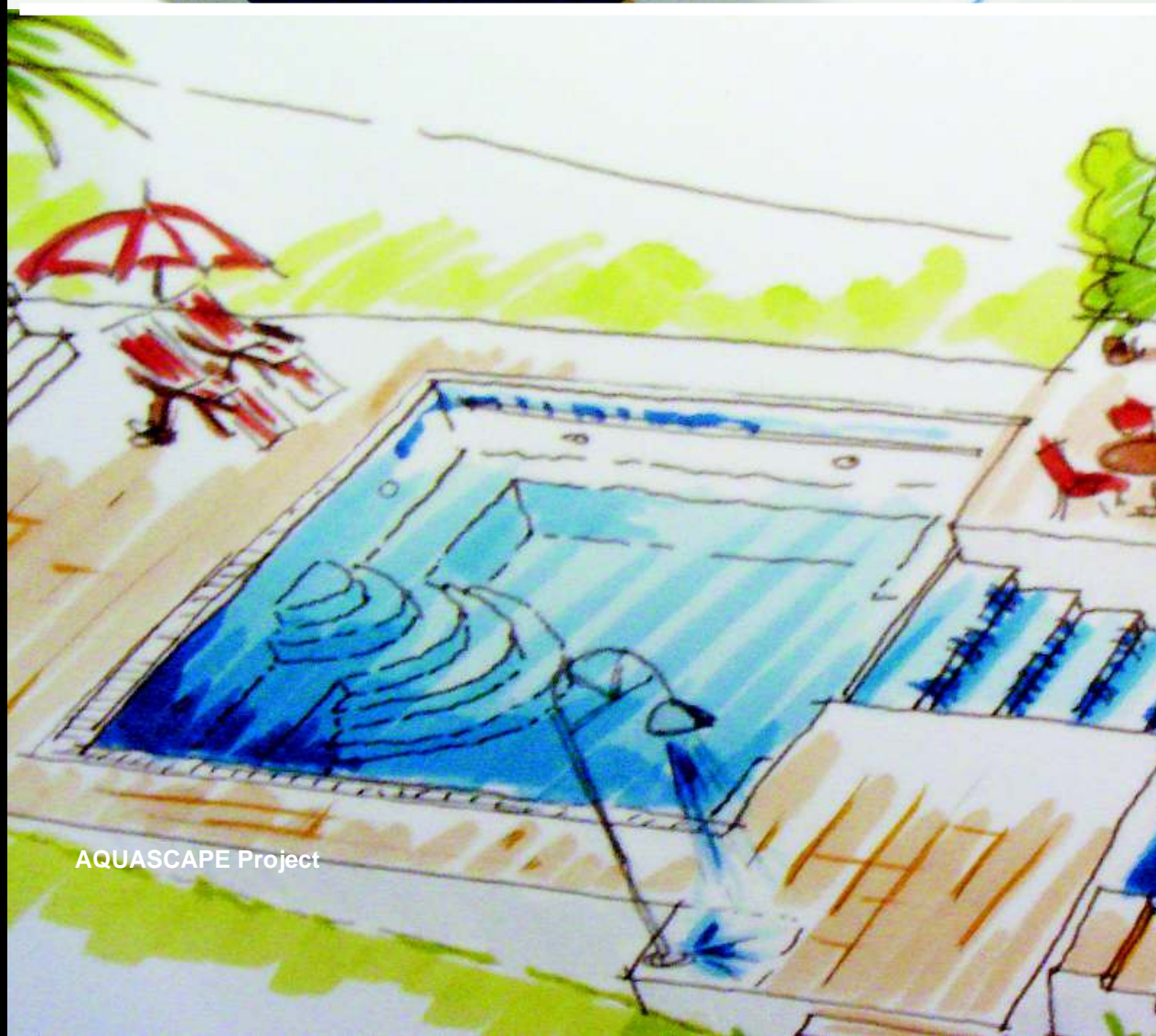
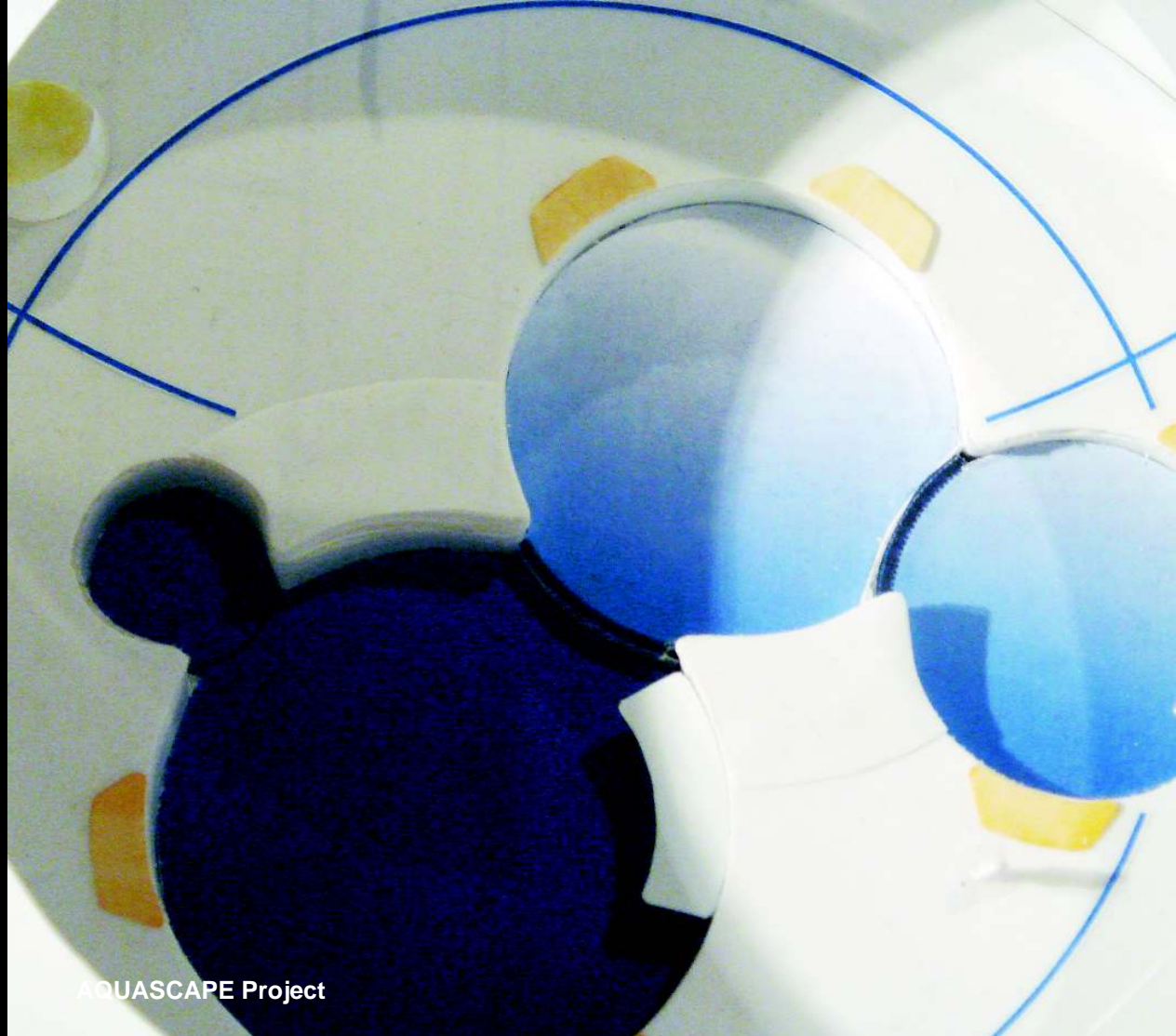



AQUASCAPE brings you

100% Chemical Free Pool water!

Copper + Silver Ionisation
WATER TREATMENT SYSTEM
Pure, Fresh & Clear Water

Ancient Greeks and Egyptians stored water in silver and gold containers to keep it fresh. Thousands of years later, NASA is still using copper-silver ionization in its space programme. This water disinfection technology has gained wide acceptance across America, Europe and Australia.

The system is derived from the centuries old principle of electro-physical water treatment based on the ionization of copper and silver: two effective natural substances for disinfection and purification. It consists of a state of the art micro processors-controlled electronic unit and patented disinfection electrodes.

This Copper-Silver ionization 100% Chemical free Water Treatment System provides natural, odourless, soft and body friendly, water thus making hazardous irritations to eyes, skin, and airways along with unpleasant odours, repetitive pH- and chlorine level checks and costly maintenance, things of the past.

Small wonder then, this technique is used in thousands of pools and wellness domains where lasting disinfection of bacteria, viruses and algae is required.

Stop
using
chemicals
in your
pool.

COMPARISON CHLORINE / IONISATION

Comparison with the standard water disinfection method

Chlorine	Copper/Silver
1.Reddened, irritated eyes.	1.No eye irritation.
2.Dry, rough skin.	2.Silky-soft skin.
3.Marked odour.	3.Odourless water.
4.Respiratory tracts irritation.	4.Water contains no irritants.
5.Chlorine is hazardous.	5.Copper is healthy (essential).
6.Needs flocculator application.	6.Natural flocculation.
7.Needs add-on agents (winter).	7.No additional agents needed.
8.Needs add-on algaecides.	8.No additional algaecides.
9.Needs storage/replenishment.	9.No storage required.
10.Needs chlorine-level checks.	10.Copper-level check 3 monthly.
11.Risk of chemical burns from liquid chlorine.	11.Fully automatic and safe discharge of ions.
12.Needs additional agents to regulate pH level.	12.No additional agents needed to regulate pH level.
13.Corrosion risk (pool materials and environment).	13.No corrosive effects(pool materials and environment).
14.Low buffer capacity.	14.Constant discharge of ions.
15.Annual replacement of chlorinated water.	15.Replacement of water not required.
16.Replacement of filter sand every 2-3 years.	16.Replacement of filter sand every 10 years.
17.Rapid loss of efficacy if exposed to strong sunlight.	17.Efficacy not affected by environmental conditions.
18.Backwash water must be disposed.	18.Backwash water ideally suited for irrigation of plants.

Average copper levels in food

AQUASCAPE : Disinfected Water 0.5 - 0.7 mg/l

cow milk :	0.4 mg/kg	potatoes :	2.2 mg/kg
poultry :	3.4 mg/kg	cabbage :	1.5 mg/kg
eggs :	2.5 mg/kg	dried vegetables :	9.0 mg/kg
white bread :	2.0 mg/kg	nuts :	5.0 mg/kg
oat flakes :	8.8 mg/kg	apples & pears :	0.9 mg/kg
rice :	1.8 mg/kg	banana :	1.3 mg/kg

Water is life

ENSURE ITS PURITY
NATURALLY,
WITHOUT CHEMICALS

Copper-Silver Ionisation

Within just a fraction of a second, the positively charged copper and silver ions form electrostatic bonds with the negatively charged areas of the cell walls of the micro-organisms, impairing the micro-organism permanently.

Once copper and silver penetrate an algae or germ cell, they attack the sulphur based amino acids in the cell proteins required by the cell for photosynthesis. As a result the cell dies. Cryptosporidium, E.coli, coliforms, pseudomonas and legionellae and many other species of bacteria and germs including chlorine resistant varieties are instantly eliminated. For this reason, electro-physical water disinfection is one of the most common alternatives to conventional 'chemical warfare'.

Other Applications

Where control of waterborne bacteria is needed : • Grey water tanks • Holding tanks • Water systems in hospitals, hotels, resorts, commercial complexes • Green buildings • Plant nurseries etc.

Create Wave in your personal Swimming pool

Energy



7.00 a.m.
 7.00 a.m. I get up and dive into my swimming pool, the waves are fortifying and will give me energy for the whole day.



12.00 a.m.
 12.00 a.m. I come back home and I swim a few lengths in a friendly swell. I unwind and relax after work and this fills me with energy. The air bubbles act as a reset, I am now ready for a busy afternoon.

Fun



4.00 p.m.
 4.00 p.m. My children are back from school and they have a good time in the waves. They took out the pirate ship and stand out to sea to look for treasure island....

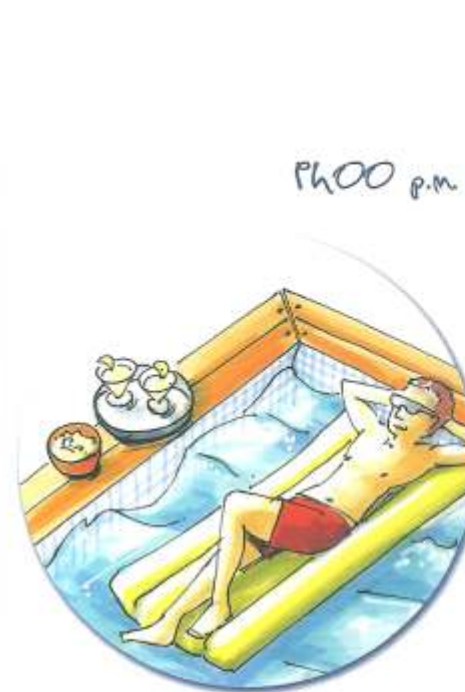

6.00 p.m.
 6.00 p.m. I have an aperitif on my air bed, rocked by the gentle waves. Nothing is important anymore....except for this very moment I breathe.

Relax

Holidays



9.00 p.m.
 9.00 p.m. Kids are sleeping now, our friends have just arrived.... The fish barbecue is ready... On the edge of the swimming pool we seem to be on holiday, the light breeze, the sound of the sea, the grilled fish and the rose wine...isn't this wonderful?



0.00 p.m.
 0.00 p.m. Ready for a midnight dip? Yes, that if life!

Freedom

Prestige

Wave-it, a pool to your rhythm!

Let your pool sparkle with Wave-It, give it rhythm, bring it to life... it will give it back to you in hundredfold ... And it is so easy to handle: just choose the kind of waves you want and enjoy ...

With its bubbles, Wave-It waves it on your request.

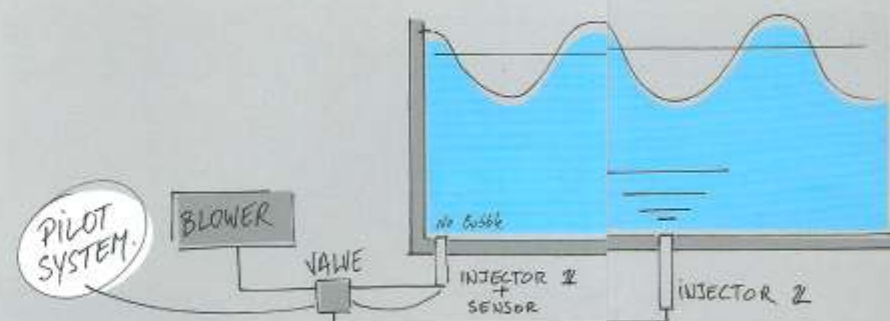

WWW.WIEGAND-MAELZER.DE

WE CREATE EMOTIONS

®

AQUASCAPE

Water!
We
made it
an
industry
in
India.



MADE IN GERMANY



4 WORLD PREMIERS IN ONE PROJECT

THERME LOIPERSDORF



Aquascape, Kohinoor Corner, V. S. Marg, Prabhadevi, Mumbai - 400 025 T: +91 22 6610 2940 / 6610 2950 F: +91 22 666 8882 Mob.: +91 989 25 10002 E: kishoramrutkar@gmail.com www.aquascapeworld.com

BOOMERANG / SIDEWINDER COMBO

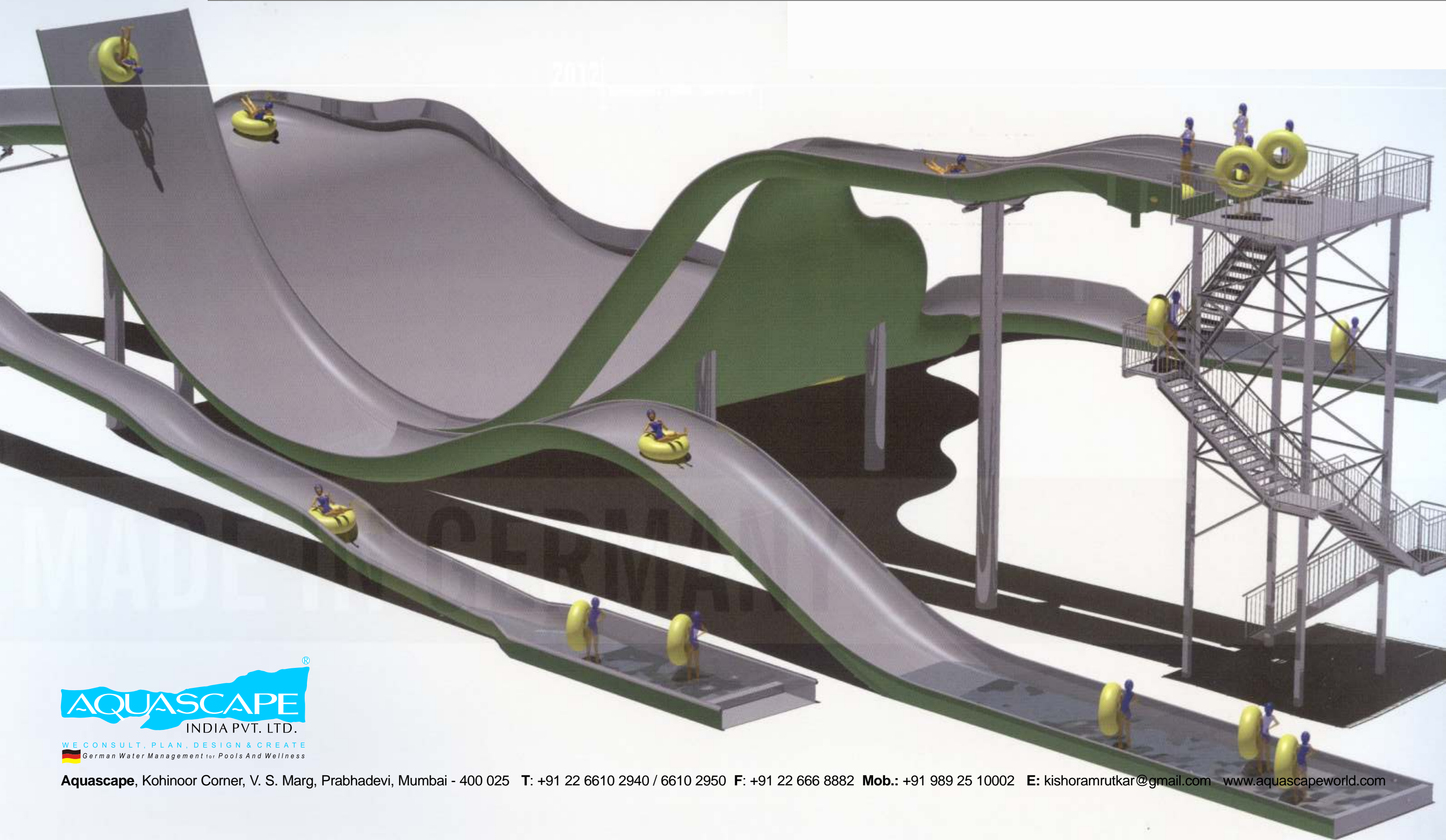

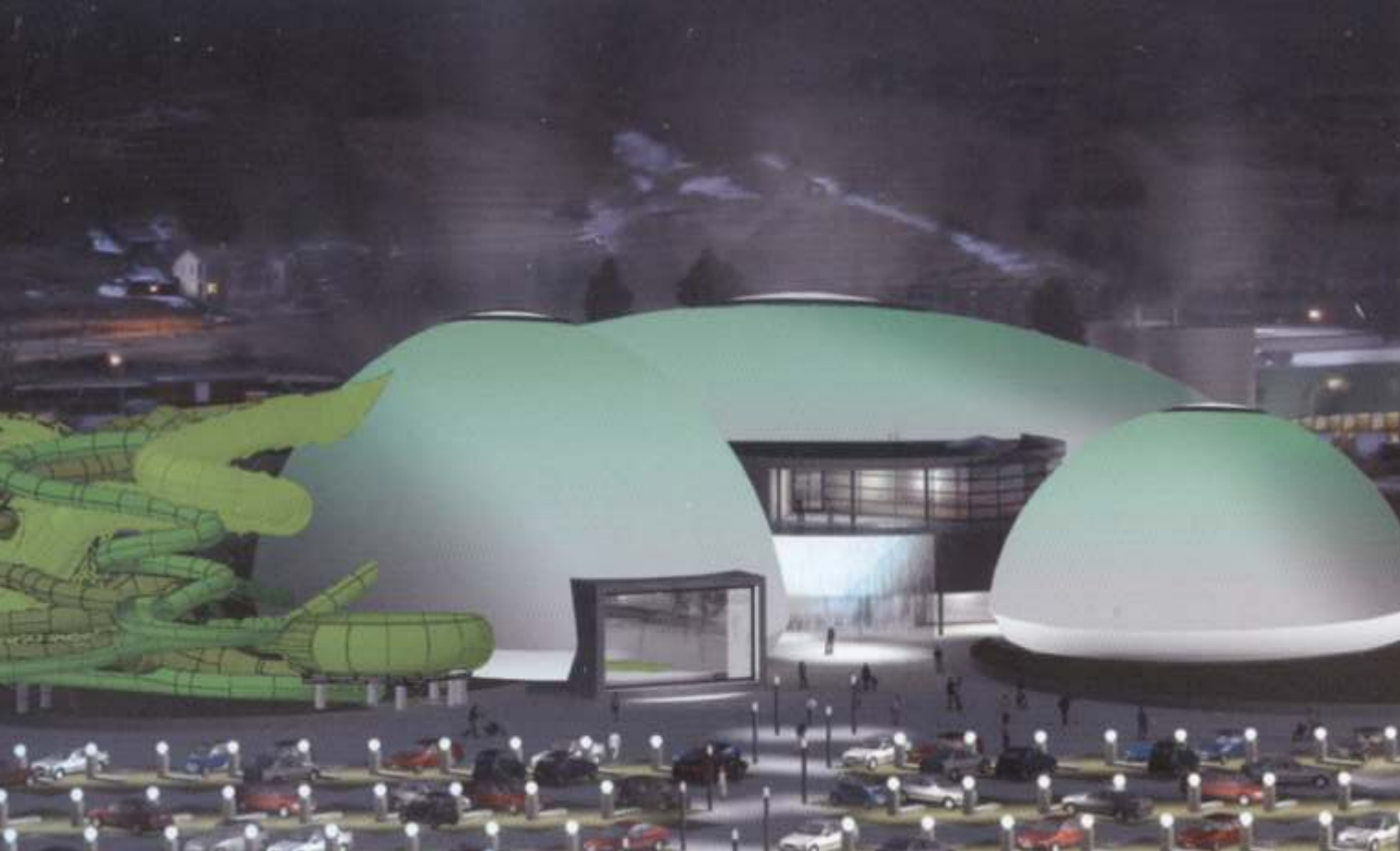

WATER KINGDOM MUMBAI
an AQUASCAPE project



AQUASCAPE
INDIA PVT. LTD.
WE CONSULT, PLAN, DESIGN & CREATE
German Water Management for Pools And Wellness

Aquascape, Kohinoor Corner, V. S. Marg, Prabhadevi, Mumbai - 400 025 T: +91 22 6610 2940 / 6610 2950 F: +91 22 6610 8882 Mob.: +91 989 25 10002 E: kishoramrutkar@gmail.com www.aquascapeworld.com

AQUASCAPE®

Water!
We
made it
an
industry
in
India.





AQUASCAPE brings you

Globes!

UNIQUE INDOOR & OUTDOOR
LIGHTING CONCEPT

Nothing like this has lit up
pools, homes and gardens
ever before!

INNOVATIVE FEATURES

- **Light & Sound**
- **Floating battery Lights**
- **Landscape Lights**
- **Up-lit Lights**
- **Cloud Effect Lights**
- **Anywhere Lights**
- **Art Collection**
- **Array of Colours**
- **Bluetooth control**
- **Remote operation**

AQUASCAPE®

Water!
We made it
an
industry
in
India.

The Aqua Waveball

From small undulations to waves like those on the open sea, the Aqua - Wave Brings animation to your pool and transforms it into a wonderful aquatic park without any modification to the pool structure. Floating on the water surface, the Aqua - Wave animates foam rubber toys, rubber rings and other leisure accessories, for everybody's pleasure, and gives the swimmers an amazing feeling of freedom.

As a result of many years of research and development in the fields of physics, electronics, mechanics and data processing, the Aqua - Wave is therefore a high-tech system, working on the principle of resonance, protected by a worldwide patent in more than 50 countries.

Since 1993, the Aqua - Wave has been sold all over the world and animates aquariums as well as Olympic pools. Nearly 300 prestigious references, mostly in Germany, France, Israel, Japan, Russia & Taiwan, show the growing keen interest of the public.

The energy consumption is incredibly low: less than 4 KW for the biggest model, that is to say two to (2 to 4) watts a cubic meter !!!



Working Principle

The majority of wave generators consume huge amount of energy which is spread and lost for good after being injected in the pool. On the contrary, the Aqua - Wave cleverly makes use of the energy present in the pool for an impressive result.

Based on the resonance principle, the Aqua - Wave is managed by a software which takes into account the working parameters of the pool, such as the number of swimmers, the wall profiles,...



The Aqua - Wave pushes on the water and creates the first wave which spreads through the pool.

Once reflected by the walls, this wave comes back towards the ball. The control unit accurately determines the moment and the power to give to the next impulse in order to amplify (or reduce) the waves.

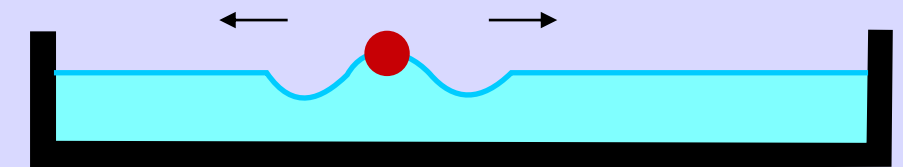

Small waves are created by the ball.

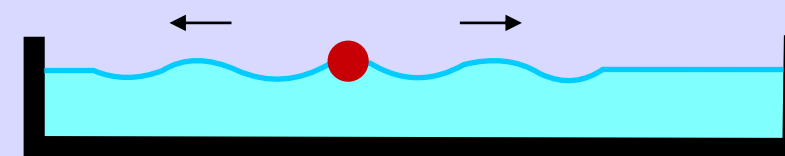

They spread towards the pool walls and are then reflected by them.

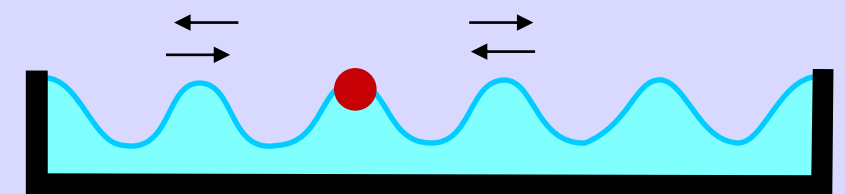

The waves are amplified by each move of the ball.

Customized Waves

Each wave is featured by numerous parameters, amongst which the amplitude (or height), the wave length (distance between two crests) and the frequency (oscillation speed).

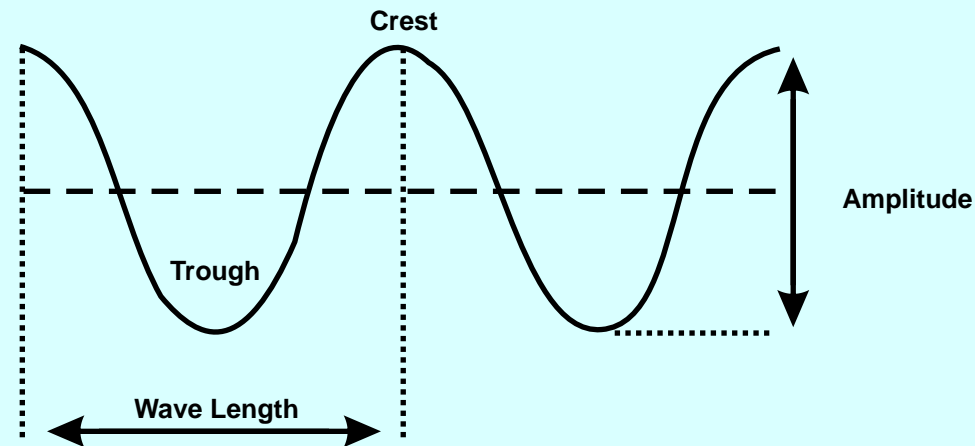

Amplitude and frequency sensors are placed in the heart of the Aqua Wave ball

During the installation, several types of waves are tested and analysed. Four of them can be chosen and their characteristics memorised in the control software. A single push on the corresponding button on the remote control unit is enough to activate them.

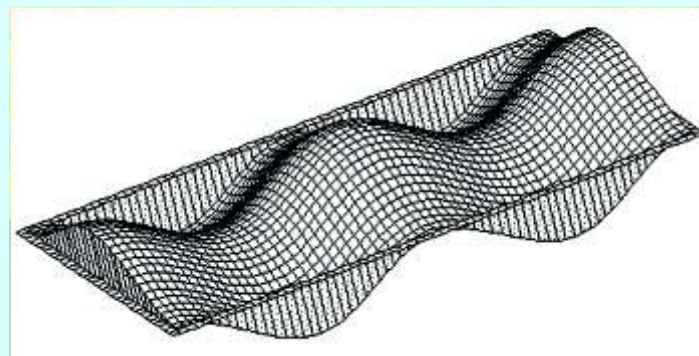

**It only takes a few hours to install the Aqua - Wave in your pool!
Contact us to receive a customized offer !**

When the Aqua - Wave is started, the sensors analyse the first waves characteristics which are then compared to the selected wave type. The control software gives the appropriate instructions to the engine which adapts its speed. So, the Aqua - Wave is instantly and continuously managed in order to produce the selected type of waves, whatever the conditions.





Anchorage Of The Aqua - Wave

For the optimum safety of the swimmers, the Aqua - Wave is kept in working position by means of an anchorage system attached either to ceiling or to the bottom of the pool.

1. ANCHORAGE SYSTEM AT THE CEILING



Ball attached to the ceiling



Anchorage to an overhanging cable

2. ANCHORAGE SYSTEM TO THE BOTTOM OF THE POOL

This is the most usual system. The anchorage system is fixed to the Aqua - Wave working place. There are different possibilities depending on the period of use of the Aqua - Wav

- For rentals or demonstrations, a removable plate is laid on the bottom of the pool;
- For a scheduled use in a pre-existent pools, an anchoring plate is stuck to the pool; bottom by means of a waterproof extra strong glue;
- For a scheduled use in a new pool, a specific anchorage piece (made of stainless steel) can be sealed in the concrete.

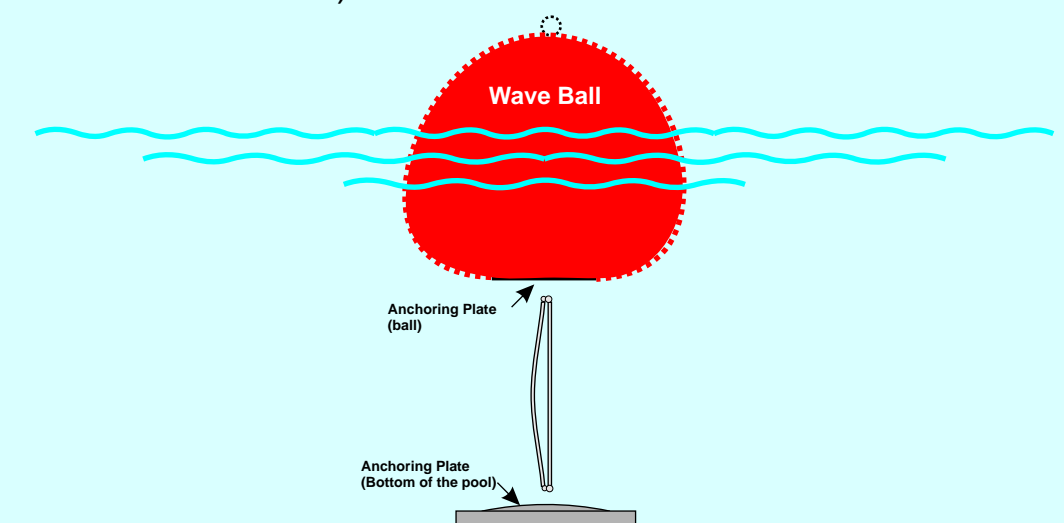

Anchoring plate fixed to the bottom of the pool

®
AQUASCAPE

Water!
We
made it
an
industry
in
India.

Technical Data Sheet

SURFACE AREA OF THE POOL *(m ²)	35 - 110	40 - 140	50 - 200	60 - 240	70 - 350	80 - 400	100 - 500	100 - 600	130 - 800
Wave Ball MODEL	W105FL	W105F	W130FL	W130F	W150FL	W150F	W165FL	W165F	W180F
Weight (kg)	180	210	330	420	500	580	780	800	1080
Diameter (cm)	105	105	130	130	150	150	168	168	180
Maximum Power (KW)	0.5	0.7	0.9	1.5	1.7	1.9	2.5	3.0	4.5
Highest waves in optimum conditions (cm)	120	140	150	160	170	180	190	210	230
Minimum necessary depth under the ball (cm)	110	140	125	150	140	160	150	170	180
Power Supply : Singleph. (S) / Triph . (T)	S	S	S	T	T	T	T	T	T





AQUASCAPE
INDIA PVT. LTD.

WE CONSULT, PLAN, DESIGN & CREATE
German Water Management for Pools And Wellness

Aquascape, Kohinoor Corner, V. S. Marg, Prabhadevi, Mumbai - 400 025 T: +91 22 6610 2940 / 6610 2950 F: +91 22 666 8882 Mob.: +91 989 25 10002 E: kishoramrutkar@gmail.com www.aquascapeworld.com